

# LINEAR MOTION TECHNOLOGY



**WRC series**  
Wide Rail Ball Type Linear Guide Series

## Ordering information

### Model code

WRC	U	21/15	M	N	B	2	C	V1	P	-1480L	-20	-20	II	/J	
															Customization code (Please refer to page 30)
															Number of rails on the same moving axis
															End hole pitch (mm)
															Starting hole pitch (mm)
															Rail length (mm)
															Accuracy grade : UP, SP, P, H, N (Please refer to page 29)
															Preload class : VC, V0, V1, V2 (Please refer to page 23)
															C: with ball chain (Please refer to page 07)
															Block quantity
															Seal type : B: Low friction
															Block length : N: standard
															Block width : M: standard F: flanged
															Block type : 21/15 , 27/20
															U: rail ( tapped from the bottom)
Product type : WRC: Wide Rail Ball Type Linear Guide Series															

## Dimensions Table

### WRU Series Rail (tapped from the bottom)

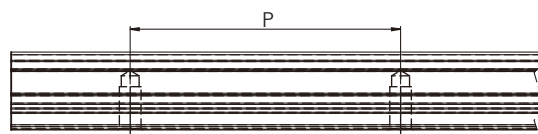
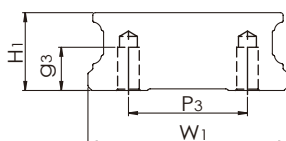

Model Code	W <sub>1</sub>	H <sub>1</sub>	P	P <sub>3</sub>	Mxg <sub>3</sub>	L <sub>max</sub>	Rail(g/m)
WRU 21/15	37	14.4	50	22	M4x8	4000	3596
WRU 27/20	42	18.5	60	24	M5x7.5	4000	5259

Dimensions Table

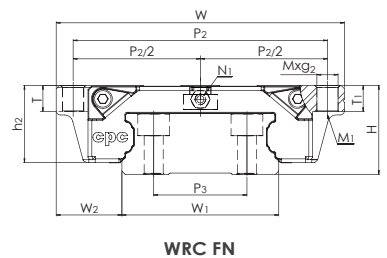
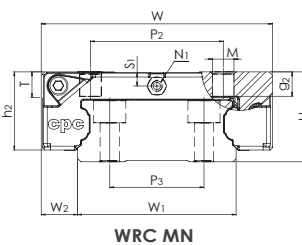

WRC Series

Model Code	Mounting Dimensions		Rail Dimensions(mm)					Block Dimensions(mm)											
	H	W <sub>2</sub>	W <sub>1</sub>	H <sub>1</sub>	P	P <sub>3</sub>	DxdxG <sub>1</sub>	W	L	L <sub>1</sub>	h <sub>2</sub>	P <sub>1</sub>	P <sub>2</sub>	P <sub>2</sub> /2	MxG <sub>2</sub>	M <sub>1</sub>	T	T <sub>1</sub>	N <sub>1</sub>
WRC 21/15 MN	21	8.5	37	14.4	50	22	7.5x4.5x5.3	54	57.5	40.3	18.3	19	31	-	M5x5	-	6	-	M3
WRC 21/15 FN	21	15.5	37	14.4	50	22	7.5x4.5x5.3	68	57.5	40.3	18.3	29	60	30	M5x7	M4	7	7	M3
WRC 27/20 MN	27	10	42	18.5	60	24	7.5x4.5x5.3	62	70	52	23.5	32	46	23	M6x6	-	10	-	M3
WRC 27/20 FN	27	19	42	18.5	60	24	7.5x4.5x5.3	80	70	52	23.5	40	70	35	M6x9	M5	9	9	M3

WRC...C Series **Ball chain type**

Model Code	Mounting Dimensions		Rail Dimensions(mm)					Block Dimensions(mm)											
	H	W <sub>2</sub>	W <sub>1</sub>	H <sub>1</sub>	P	P <sub>3</sub>	DxdxG <sub>1</sub>	W	L	L <sub>1</sub>	h <sub>2</sub>	P <sub>1</sub>	P <sub>2</sub>	P <sub>2</sub> /2	MxG <sub>2</sub>	M <sub>1</sub>	T	T <sub>1</sub>	N <sub>1</sub>
WRC21/15MN...C	21	8.5	37	14.4	50	22	7.5x4.5x5.3	54	57.5	40.3	18.3	19	31	-	M5x5	-	6	-	M3
WRC 21/15FN...C	21	15.5	37	14.4	50	22	7.5x4.5x5.3	68	57.5	40.3	18.3	29	60	30	M5x7	M4	7	7	M3
WRC 27/20MN...C	27	10	42	18.5	60	24	7.5x4.5x5.3	62	70	52	23.5	32	46	23	M6x6	-	10	-	M3
WRC 27/20FN...C	27	19	42	18.5	60	24	7.5x4.5x5.3	80	70	52	23.5	40	70	35	M6x9	M5	9	9	M3

# LINEAR MOTION TECHNOLOGY

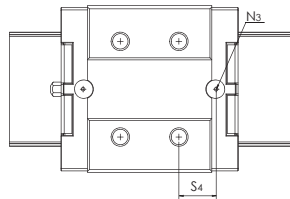

WRC 21/15MN

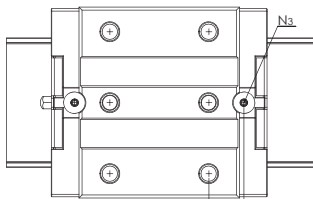
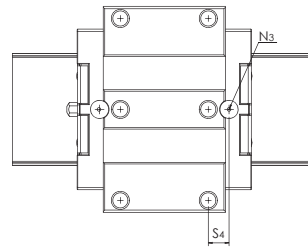

WRC 27/20MN

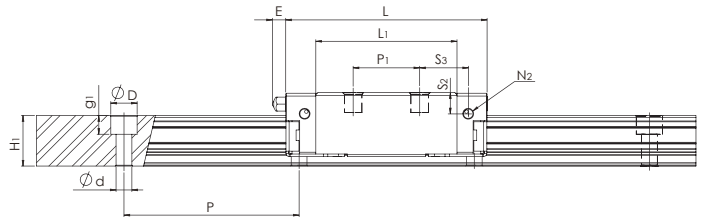

Block Dimensions(mm)							Load Capacities (KN)		Static Moment (Nm)			Weight		Model Code	
N2	N3	E	S1	S2	S3	S4	C <sub>iso</sub>		C <sub>0</sub>	Mr <sub>0</sub>	Mp <sub>0</sub>	My <sub>0</sub>	Block(g)		Rail(g/m)
							100km	50km							
M3x3	P3	3.5	3.3	6.1	13.9	11.9	9.9	12.5	17.5	315	105	105	160	3596	WRC 21/15 MN
M3x3	P3	3.5	3.3	6.1	8.9	6.9	9.9	12.5	17.5	315	105	105	198	3596	WRC 21/15 FN
M3x4	P4	3.5	4.5	8	13.2	11.5	17.1	21.5	30	634	230	230	320	5259	WRC 27/20 MN
M3x4	P4	3.5	4.5	8	9.2	7.5	17.1	21.5	30	634	230	230	553	5259	WRC 27/20 FN

The above rating load capacities and static moments are calculated according to the ISO14728 standard. The rating life for basic dynamic load ratings is defined as the total 100km travel distance for 90% of a group of identical linear guides under the same conditions and free from any material damage caused by rolling fatigue. If a standard of 50km travel distance is applied to measure the average product lifespan, the above basic dynamic load rating C should be multiplied by 1.26 for an accurate conversion.

Block Dimensions(mm)							Load Capacities (KN)		Static Moment (Nm)			Weight		Model Code	
N2	N3	E	S1	S2	S3	S4	C <sub>cage</sub>		C <sub>0</sub>	Mr <sub>0</sub>	Mp <sub>0</sub>	My <sub>0</sub>	Block(g)		Rail(g/m)
							100km	50km							
M3x3	P3	3.5	3.3	6.1	13.9	11.9	11.8	14.9	16.2	295	95	95	159	3596	WRC21/15MN...C
M3x3	P3	3.5	3.3	6.1	8.9	6.9	11.8	14.9	16.2	295	95	95	197.5	3596	WRC 21/15 FN...C
M3x4	P4	3.5	4.5	8	13.2	11.5	22.3	28.1	25.7	535	200	200	318	5259	WRC 27/20 MN...C
M3x4	P4	3.5	4.5	8	9.2	7.5	22.3	28.1	25.7	535	200	200	550	5259	WRC 27/20 FN...C

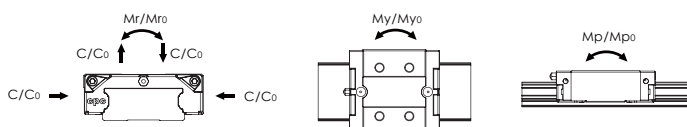

The dynamic load rating value with ball chain C<sub>cage</sub> is the measured value (please refer to page 08). The above static load rating and the static moment are calculated according to the ISO 14728 standard.